

ALL INFORMATION CONTAINED IN THIS DRAWING IS THE SOLE PROPERTY OF THE UNITED STATES GOVERNMENT AND IS LOANED TO YOU BY THE UNITED STATES GOVERNMENT. IT IS TO BE REPRODUCED AND TRANSMITTED IN ANY FORM OR BY ANY MEANS, ELECTRONIC OR MECHANICAL, INCLUDING PHOTOCOPYING, RECORDING, OR BY ANY INFORMATION STORAGE AND RETRIEVAL SYSTEM, WITHOUT PERMISSION IN WRITING FROM THE UNITED STATES GOVERNMENT.

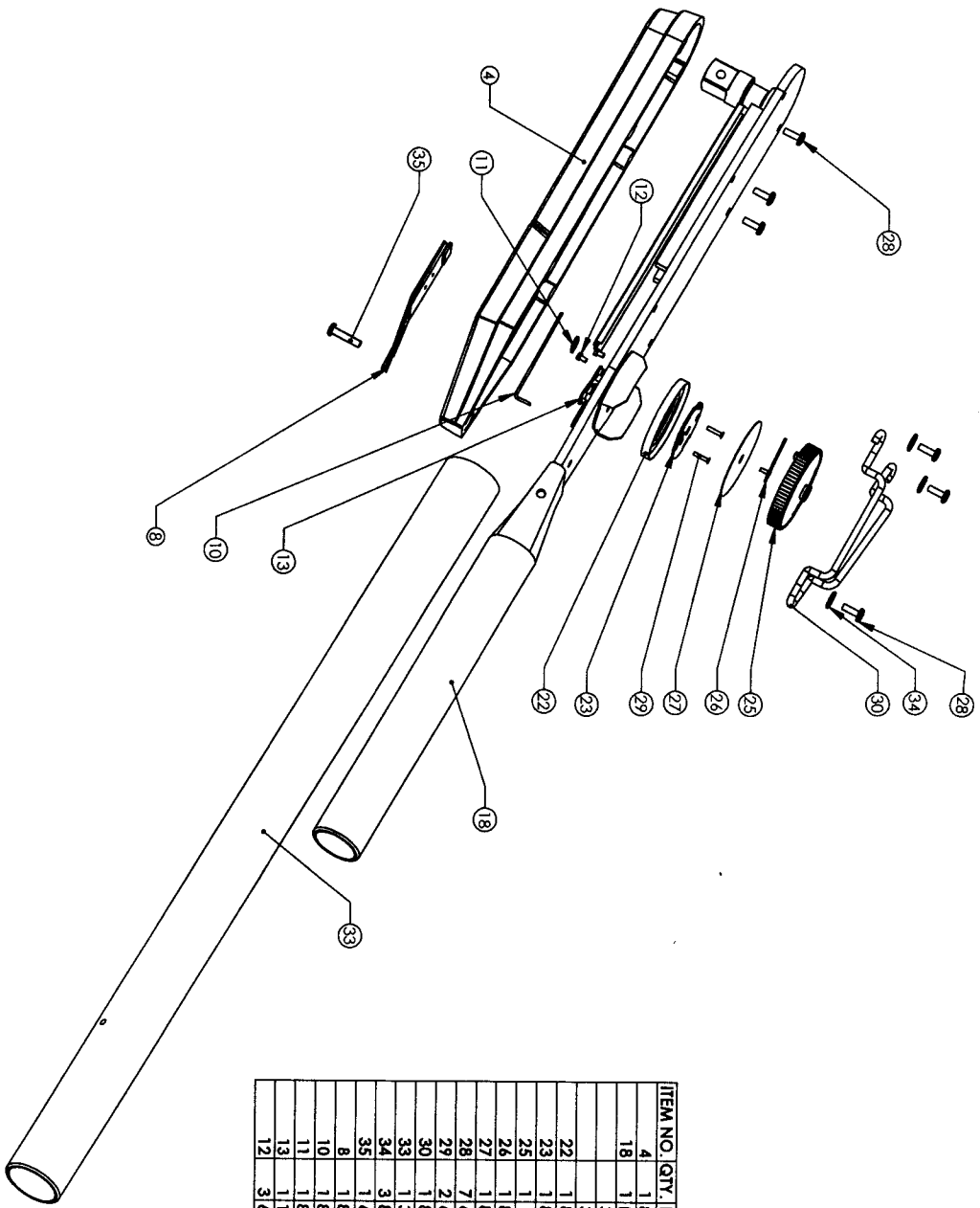

ITEM NO.	QTY.	PART NO.	DESCRIPTION
4	1	85-0001	Cover, D4 Housing
18	1	(Choose Range)	TOP Plate Assy
		38-0017	0-350 H. lb.
		38-0018	0-600 H. lb.
22	1	81-0074	Shell, Follower
23	1	81-0073	Shell, Fixed
25	1	81-0072	Bezel, Mem. Needle Assy
26	1	81-0119	Pointer Needle, Red
27	1	81-0077-Model	Scale, Dial (Specify Model)
28	7	60-0019	Screw, Hex Button 10-32
29	2	60-0006	Screw, Ch. Hd.
30	1	85-0052	Guard Wire
33	1	38-0006	Extension Assy, 600 H. lb.
34	3	81-0116	Washer, SAE #10
35	1	60-0017	Screw
8	1	85-0047	Cover, Battery D3
10	1	81-0071	Bar, Push
11	1	81-0087	Clamp, Push Bar
13	1	1730	Movement
12	3	60-0006	Screw

UNLESS OTHERWISE SPECIFIED, DIMENSIONS ARE IN INCHES.		PARTS LIST	
DATE	BY	DATE	BY
D4 Platform-Parts List		0-350 H. lb.	
		0-600 H. lb., Non Electric	
		35-0006	